

SIGN	DATE	DESCRIPTION	APPROVER

Material

- Contact pin: Brass
- Surface of solder tail: Tin plated
- With flange nut: brass M2.5
- Insulator (housing): Thermoplastic (UL94V-0)

Electrical

- Voltage rating: 300VAC
- Current rating: 15A
- Withstanding Voltage: 1.6KV
- Operating temperature: -30°C to +105°C
- Soldering temperature: 250°C±10°C/5 Sec
- Safety approval: (cULus) pending

RoHS Compliant

PART NUMBER:

OSTVFXX5250

- | | |
|----------------|---------------------|
| No. of Poles | COLOR |
| 04: 2x02 Poles | 0: Black |
| 06: 2x03 Poles | 5: Green (Standard) |
| : | 6: Blue |
| 48: 2x24 Poles | 8: Grey |

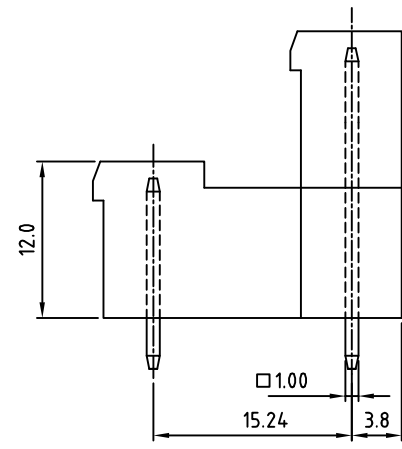
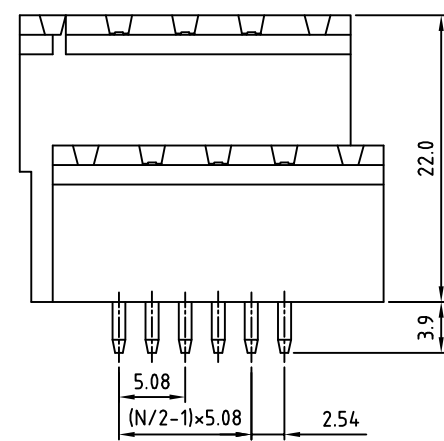
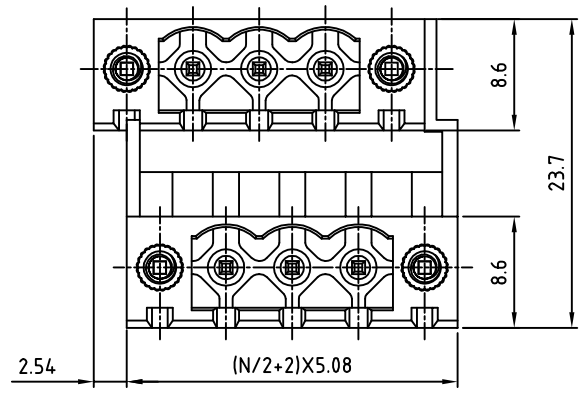

N= Number of poles

P.C.B LAYOUT

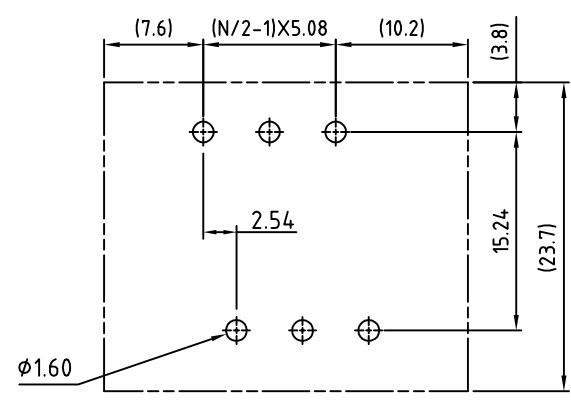

THESE DRAWINGS AND SPECIFICATIONS ARE THE PROPERTY OF ON-SHORE TECHNOLOGY, INC. AND SHALL NOT BE REPRODUCED, COPIED OR USED IN ANY MANNER WITHOUT THE PRIOR WRITTEN CONSENT OF ON-SHORE TECHNOLOGY, INC.



TITLE		OSTVF-5.08mm Series vertical W/Flange 2x2p-2x24p			
PART NO.	OSTVFXX5250	DWG NO.	OSTVFXX5250.DWG		
APPROVED	CHECKED	DESIGNED	DRAWN	CUST NO.	Tolerance
Shi Jun 2006.11.07	Marvin 2006.11.07	Marvin 2006.11.07	Marvin 2006.11.07		X. ±0.50
					X.X ±0.30
				SHEET: 01/01	X.XX ±0.10
				REV: C	X° ±1°