

THIS DOCUMENT IS THE PROPERTY OF  
KEYSTONE ELECTRONICS CORP. AND  
SHALL NOT BE REPRODUCED, DISTRIBUTED  
OR USED AS A BASIS FOR MANUFACTURE  
WITHOUT PRIOR WRITTEN PERMISSION  
FROM KEYSTONE ELECTRONICS CORP.

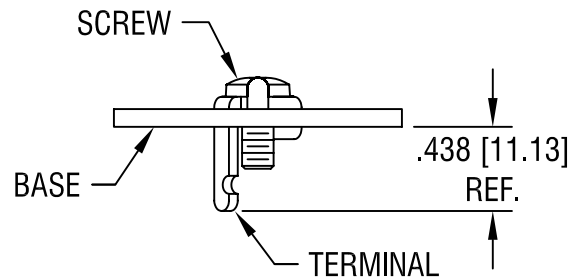
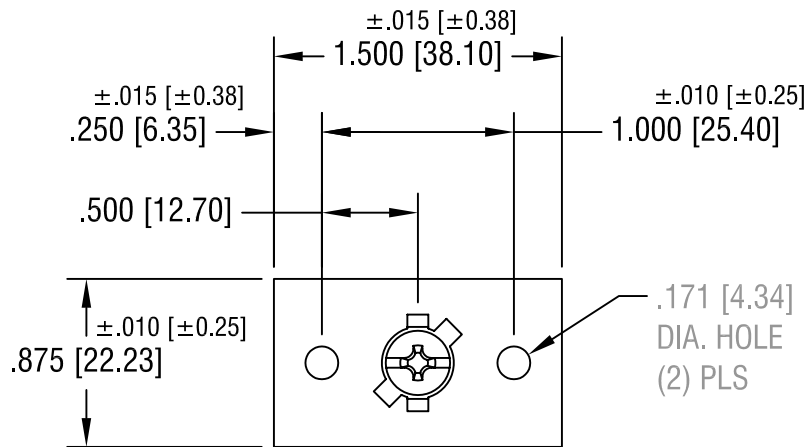

NOTES:

1. BASE:  
MAT'L: .093 [2.36] TH'K G-10 GLASS EPOXY
2. TERMINAL: P/N 1209  
MAT'L: .064 [1.63] TH'K BRASS, TIN PLATE  
SCREW: 8-32 THREAD  
MAT'L: BRASS, NICKEL PLATE

**KEYSTONE ELECTRONICS CORP.**

ASTORIA, N.Y. 11105-2017

PART NAME

HEAVY DUTY BINDING POST STRIP

MATERIAL

AS NOTED

FINISH

AS NOTED

DRN BY

BOONE

DATE

12.12.06

APP'D

LN

SCALE

1X

TOLERANCES

INCH [MM]

DECIMAL ±.005 [±0.15]

ANGULAR ± 1°

UNLESS OTHERWISE SPECIFIED

CODE

C/M

DWG NO.

4147

DATE	DESCRIPTION	REV.