

FRONT SHELL

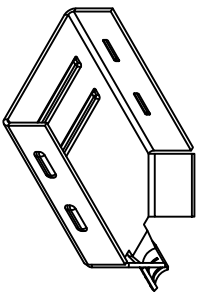

INSERTED BODY

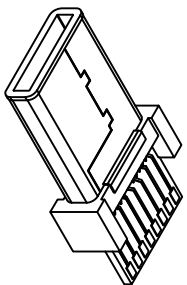

REAR SHELL

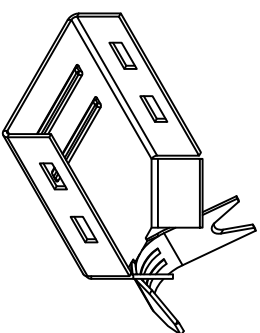

ASSEMBLED PLUG

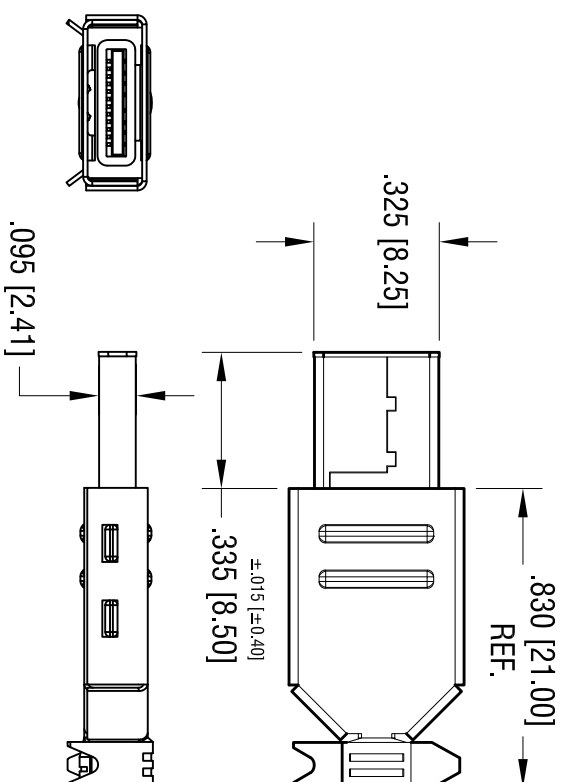
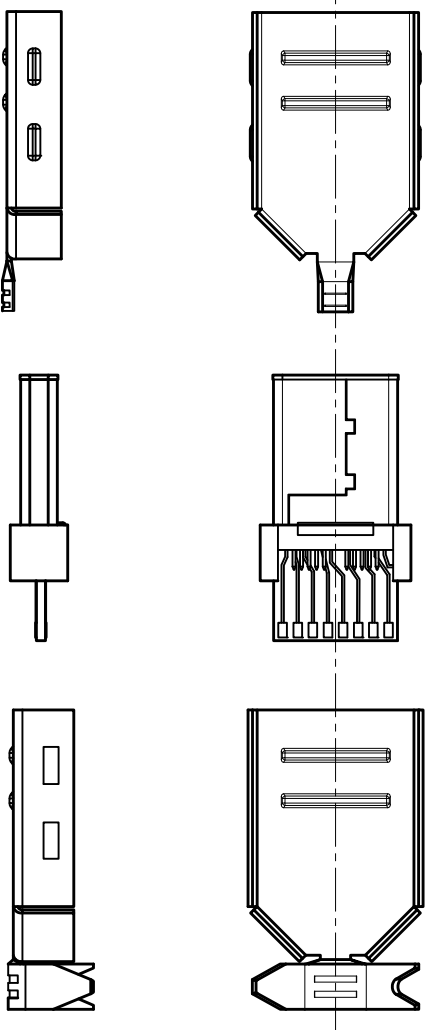
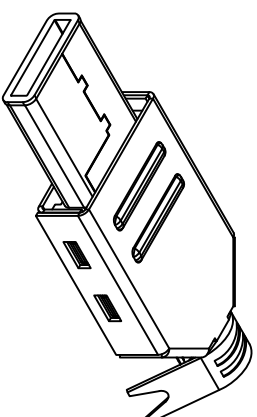

NOTE:

1. SHELL: STAINLESS STEEL, NICKEL PLATED
2. CONTACT: MAT'L PHOSPHOR BRONZE, GOLD PLATE
3. INSULATOR: LCP, UL 94V-0
DIELECTRIC WITHSTANDING VOLTAGE:
1000 VAC FOR 1 MIN.
4. TEMPERATURE RANGE: -20° [-30°C] TO 175° [80°C]
5. CONTACT RESISTANCE:
30mOHMS FOR ALL CONTACT MAX.
INSULATION RESISTANCE- 100 Mega OHMS MIN.
6. CURRENT RATING 0.5 AMP
7. LIFE: 10,000 CYCLES MIN.

THIS DOCUMENT IS THE PROPERTY OF KEYSTONE ELECTRONICS CORP. AND SHALL NOT BE REPRODUCED, DISTRIBUTED OR USED AS A BASIS FOR MANUFACTURE WITHOUT PRIOR WRITTEN PERMISSION FROM KEYSTONE ELECTRONICS CORP.

KEYSTONE ELECTRONICS CORP.			
www.keystecorp.com • ASTORIA, N.Y. 11105-2017 • Tel (718) 956-8900			
PART NAME		USB 3.1 TYPE C PLUG	
MATERIAL		AS NOTED	
FINISH		AS NOTED	
TOLERANCES	INCH	[MM]	CODE
DECIMAL	± .010	[± 0.25]	C
ANGULAR	± 1°		
UNLESS OTHERWISE SPECIFIED			
DRN BY	NT	DATE	4.14.15
APP'D	LN	SCALE	3X
DWG NO.		954	

DATE

4.27.17

DESCRIPTION

CHANGE AS PER ECN 17-040

REV.

A

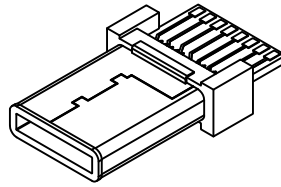
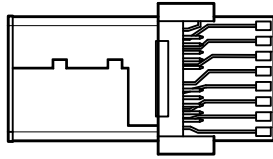

A12	A11	A10	A9	A8	A7	A6	A5	A4	A3	A2	A1
GND	RX2+	RX2-	V BUS	SBU1	D-	D+	CC	V BUS	TX1-	TX1+	GND
GND	TX2+	TX2-	V BUS	V CONN			SBU2	V BUS	RX1-	RX1+	GND
B1	B2	B3	B4	B5	B6	B7	B8	B9	B10	B11	B12

- A1 ⇔ D1
- A2 ⇔ C1
- A3 ⇔ C2
- A4 ⇔ A9, B4, B9, D4
- A5 ⇔ C3
- A6 ⇔ C4
- A7 ⇔ C5
- A8 ⇔ C6
- A9 ⇔ A4, B4, B9, D4
- A10 ⇔ C7
- A11 ⇔ C8
- A12 ⇔ D1, D8

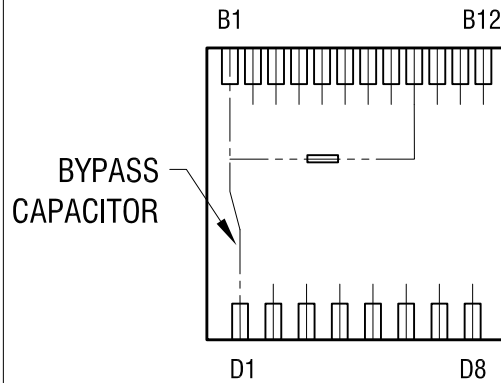
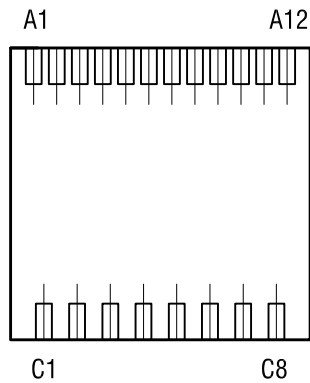

- B1 ⇔ D1
- B2 ⇔ D2
- B3 ⇔ D3
- B4 ⇔ B9, A4, A9, D4
- B5 ⇔ D5
- B6 ⇔ NIL
- B7 ⇔ NIL
- B8 ⇔ D6
- B9 ⇔ B4, A4, A9, D4
- B10 ⇔ D7
- B11 ⇔ D8
- B12 ⇔ D1

NOTE:

1. 10nF BYPASS CAPACITOR
IN BETWEEN V BUS (A4, A9, C4, C9)
AND GROUND (D1)

4.27.17	CHANGED AS PER ECN 17-040	A
DATE	DESCRIPTION	REV.

KEYSTONE ELECTRONICS CORP.			
www.keyelco.com • ASTORIA, N.Y. 11105-2017 • Tel (718) 956-8900			
PART NAME			
USB TYPE- C FUNCTIONAL PIN-OUT			
MATERIAL			
N/A			
FINISH		DRN BY	DATE
N/A		NT	3.10.17
		APP'D	SCALE
		LN	N/A
TOLERANCES	INCH [MM]	CODE	DWG NO.
DECIMAL	± .005 [± 0.13]	C	954
ANGULAR	± 1°		
UNLESS OTHERWISE SPECIFIED			