

| ITEM NO. | PART NUMBER | DESCRIPTION | QTY. | COMPONENT NOTES |
|----------|-------------|--|------|-----------------|
| 1 | 50-00129 | Connector, dc plug, 5.5x2.5xL18.5 mm, molding style, spring contacts | 1 | |
| 2 | 30-00404 | Wire, 2C TS, 24 AWG, UL2468, 300V, 80C, 3.0 mm, VW-1, PVC, 87A | 1 | |
| 3 | 24-00006 | Overmold, PVC | 1 | black |

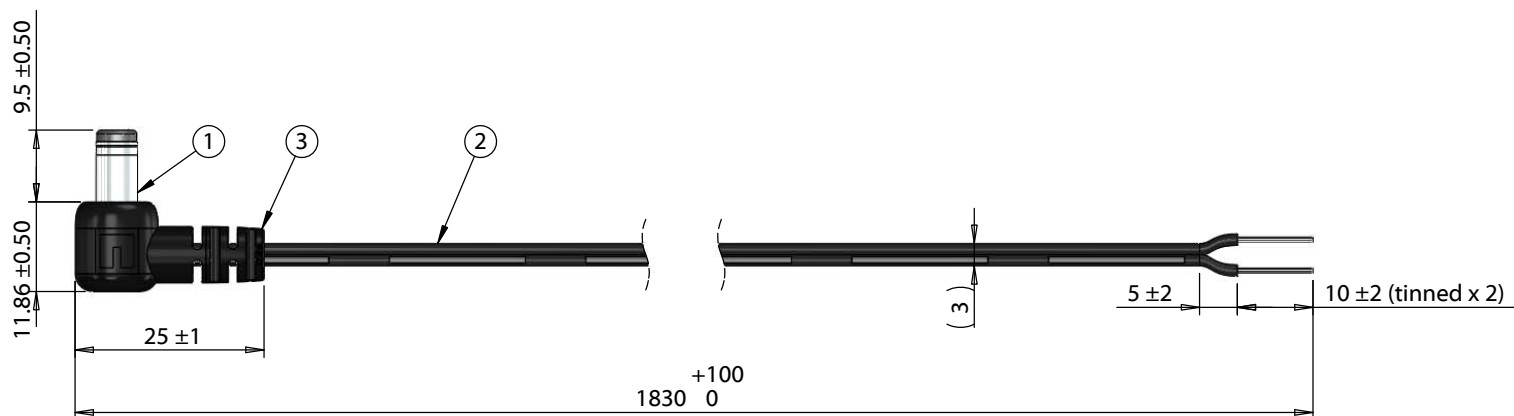
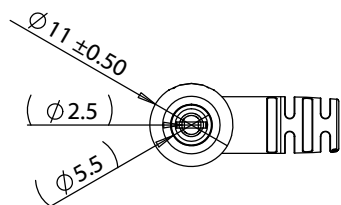

| Wiring Diagram | |
|----------------|-------------------|
| 50-00129 | wire color |
| center | black with stripe |
| sleeve | black |

Notes:
Functionally equivalent components may be substituted

| | | | | | | |
|-----------|------------|-----------------|--|--|--|--------------|
| Revision: | Date: | Description: | Prepared: | Notes: RoHS and REACH compliant Function test: no open, no short circuit, no intermittent | <h1>TENSILITY</h1> <p>tel 1.541.323.3228 800 877.670.7118 fax 1.541.323.4202 web tensility.com</p> | |
| A | 02/06/2018 | Initial release | Verified: | | | |
| | | | Dimensions are in millimeters. Tolerances: X: ± 0.5 mm X.X: ± 0.3 mm X.XX: ± 0.05 mm | Description: | Size: Part number: | |
| | | | | Cable, 1830 mm, 5.5x2.5x9.5 mm 90° 50-00129 dc plug to 10 mm tinned, 24 AWG, UL2468, 30-00404 wire | A 10-02502 | |
| | | | | Scale: 1:1 | | Sheet 1 of 1 |

5

4

3

2

1